

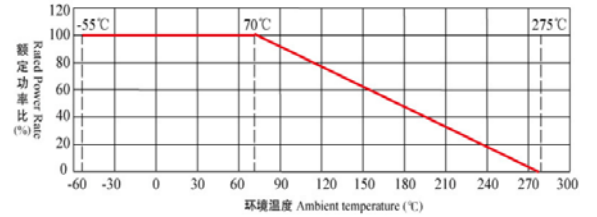

● 特性 Feature

1. 金屬鋁殼包封, 散熱性能好, 適合散熱板安裝, 可長期在惡劣環境下使用。
2. 體積小, 功率負荷大。
3. 絕緣性高, 採用阻燃無機材料一體化封裝, 抗振性好。
4. 多種接線方式, 便於安裝。
5. 廣泛用於電源, 變頻器, 電梯, 舞臺音響及高端設備行業。

● 尺寸 Dimension

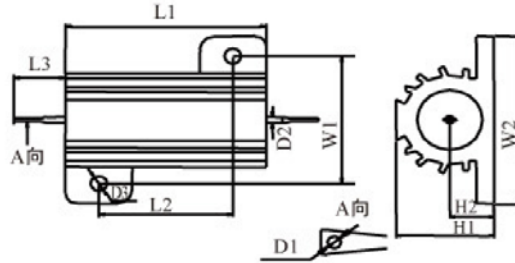

功率 Power	尺寸 Dimensions (mm)										阻值范围 Resistance range
	L1±1	L2±1	L3±1	W1±1	W2±1	H1±1	H2±1	D1±0.5	D2±0.1	D3±0.5	
5W	15.5	11.0	26.0	12.0	16.0	8.5	4.4	1.5	1.5	2.4	0R01-1K
10W	20.0	14.0	9.0	16.0	21.0	10.0	5.0	2.0	2.0	2.5	0R01-1K5
25W	28.0	18.0	11.0	20.0	27.0	14.0	7.0	2.0	2.0	3.5	0R01-10K
30W	34.0	25.0	11.0	21.5	29.0	15.5	7.3	2.0	2.0	3.5	0R01-27K
50W	50.0	40.0	11.0	21.5	29.0	15.5	7.3	2.0	2.0	3.5	0R01-33K

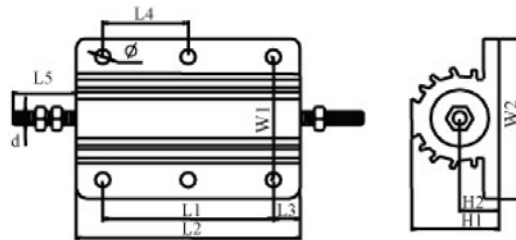

功率 Power	尺寸 Dimensions (mm)											阻值范围 Resistance range
	L1±2	L2±2	L3±1	L4±1	L5±2	W1±2	W2±2	H1±1	H2±1	d±0.5	Φ±0.5	
75W	29.0	51.0	10.0		15.0	37.0	48.0	26.0	11.5	4.0	4.4	0R01-39K
100W	35.0	66.0	10.0		15.0	37.0	48.0	26.0	12.0	4.0	4.4	0R01-51K
150W	58.0	100.0	20.0		15.0	37.0	48.0	26.0	12.0	4.0	4.4	0R01-56K
200W	70.0	91.0	10.0	35.0	20.0	57.0	71.0	45.0	20.0	6.0	5.2	0R01-62K
250W	90.0	110.0	10.0	45.0	20.0	57.0	71.0	45.0	20.0	6.0	5.2	0R01-68K
300W	104.0	130.0	10.0	52.0	20.0	57.0	71.0	45.0	20.0	6.0	5.2	0R01-75K
500W	174.0	204.0	15.0	87.0	20.0	57.0	71.0	45.0	20.0	6.0	5.2	0R01-82K

● 電氣性能 Electrical performance

Characteristics	Specifications	Test Methods
Short-time overload	10P _k , 5S	±(2% + 0.05Ω) Max.
Vibration	10HZ~55HZ-10HZ, 1.5mm, 2h	±(1% + 0.05Ω) Max
Heat resistant	350°C±5°C, 2h	±(2% + 0.05Ω) Max
Shock-proof	P _k , 30min/-55°C, 15min	±(2% + 0.05Ω) Max
Humidity-proof	40°C±2°C, RH93±3%, 240h	±(3% + 0.05Ω) Max
Endurance	70°C, P _k 500h	±(3% + 0.05Ω) Max