



● 特性 Feature

- Ceramic potting, greater safety
- There are two kinds of core which woundwire and oxide
- High power, longer load life under large load
- Wind resistance range

● 尺寸 Dimension

SQP

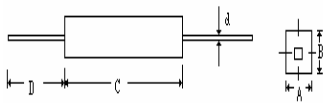
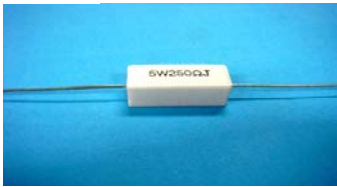

SQM

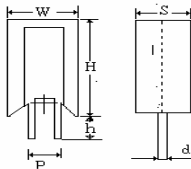

SQZ

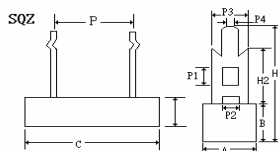

SQT



● 降功率曲線 Derating Curve

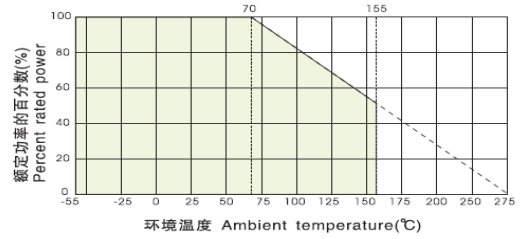

| TYPE | Dimension (mm) | | | | | Resistance Range(Ω) | |
|------|----------------|------|-------|-----|--------|---------------------|-----------|
| | A±1 | B±1 | C±1.5 | D±3 | d±0.05 | 繞線芯 | 刻槽芯 |
| 1W | 6 | 5.5 | 13 | 25 | 0.58 | 0.01~47 | 47~33K |
| 2W | 7 | 7 | 18 | 32 | 0.65 | 0.01~82 | 82~33K |
| 3W | 8 | 8 | 22 | 32 | 0.78 | 0.01~300 | 301~33K |
| 5W | 9.7 | 9.3 | 22.2 | 35 | 0.78 | 0.01~300 | 301~50K |
| 7W | 9.5 | 9.5 | 35 | 35 | 0.8 | 0.01~680 | 681~50K |
| 10WS | 13.2 | 13.2 | 22.5 | 35 | 0.8 | 0.01~1K | 1.1K~50K |
| 10W | 10 | 9.5 | 48 | 33 | 0.8 | 0.01~1K | 1.1K~50K |
| 15W | 12.5 | 12.5 | 48 | 33 | 0.8 | 0.01~1K | 1.1K~150K |
| 20W | 14 | 13 | 60 | 33 | 0.8 | 0.01~1k | 1.1k~150K |
| 25W | 14 | 13 | 60 | 33 | 0.8 | 0.01~1k | 1.1k~150K |
| 30W | 19 | 19 | 75 | 33 | 0.8 | 0.01~1k | 1.1k~150K |
| 40W | 19 | 19 | 90 | 33 | 0.8 | 0.01~1k | 1.1k~150K |

| TYPE | Dimension (mm) | | | | | | Resistance Range(Ω) | |
|------|----------------|-----|-------|-----|-------|--------|---------------------|----------|
| | W±1 | S±1 | H±1.5 | h±1 | P±0.5 | d±0.02 | 繞線芯 | 刻槽芯 |
| 2W | 11.2 | 7.2 | 20.5 | 5 | 5 | 0.8 | 0.01~150 | 151~50k |
| 3W | 12 | 8 | 25 | 5 | 5 | 0.8 | 0.01~300 | 301~100K |
| 5W | 13 | 9 | 25.5 | 5 | 5 | 0.8 | 0.01~300 | 301~100K |
| 7W | 13 | 9 | 39 | 5 | 5 | 0.8 | 0.01~500 | 501~180K |
| 10WS | 16 | 12 | 35 | 5 | 7.5 | 0.8 | 0.01~500 | 501~180K |
| 10W | 13.5 | 9 | 51 | 5 | 5 | 0.8 | 0.01~680 | 681~180K |

| TYPE | Dimension (mm) | | | | | | | | | | Resistance Range(Ω) | |
|------|----------------|------|------|-----|------|------|--------|--------|--------|--------|---------------------|----------|
| | C±1 | A±1 | B±1 | P±2 | H1±1 | H2±1 | P1±0.2 | P2±0.2 | P3±0.2 | P4±0.1 | 繞線芯 | 刻槽芯 |
| 3W | 22 | 9 | 9 | 16 | 22 | 12 | 4.2 | 2 | 7 | 1.3 | 0.1~200 | --- |
| 5W | 27.5 | 9.5 | 9.5 | 15 | 27 | 12 | 4.2 | 2 | 7 | 1.3 | 0.1~200 | 201~100K |
| 7W | 35 | 10 | 9.5 | 20 | 24 | 12 | 4.2 | 2 | 7 | 1.3 | 0.1~560 | 561~180K |
| 10W | 48 | 10 | 9.5 | 32 | 24 | 12 | 4.2 | 2 | 7 | 1.3 | 0.1~560 | 561~180K |
| 15W | 48 | 12.5 | 12.5 | 32 | 33 | 15 | 7 | 4 | 10 | 3 | 0.1~560 | 561~180K |
| 20W | 63 | 12.5 | 12.5 | 44 | 33 | 15 | 7 | 4 | 10 | 3 | 0.1~560 | 561~20K |
| 25W | 63 | 13 | 13 | 44 | 33 | 15 | 7 | 4 | 10 | 3 | 0.1~560 | 561~20K |
| 30W | 75 | 19 | 19 | 56 | 35 | 15 | 7 | 4 | 10 | 3 | 0.1~560 | 561~20K |
| 40w | 90 | 19 | 19 | 68 | 35 | 10 | 7 | 4 | 10 | 3 | 0.1~560 | 561~20K |
| 100W | 132 | 24 | 24 | 113 | 50 | 23 | 7 | 4 | 10 | 3 | 0.1~560 | 561~20K |

可根據客戶要求配置不同形狀和尺寸的端子

Can be configured according to customer requirements of different shapes and sizes of terminal

| TYPE | Dimension (mm) | | | | | Resistance Range(Ω) | |
|------|----------------|-----|------|-----|--------|---------------------|----------|
| | A±1 | B±1 | C±1 | D±3 | d±0.06 | 繞線芯 | 刻槽芯 |
| 5W | 6.5 | 7 | 26 | 35 | 0.78 | 0.01~300 | 301~100K |
| 7W | 9.4 | 9 | 35.5 | 25 | 0.78 | 0.01~500 | 501~50K |



SQPG

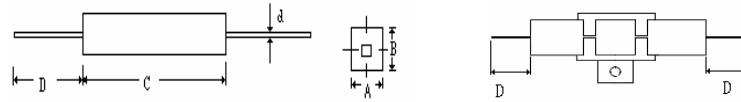
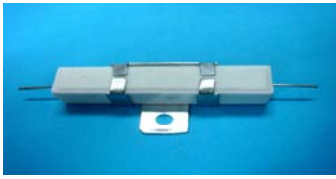

| TYPE | Dimension (mm) | | | | | Resistance Range(Ω) | |
|------|----------------|------|-------|-----|--------|---------------------|----------|
| | A±1 | B±1 | C±1.5 | D±3 | d±0.05 | WIREWOUND | MOR |
| SQP | | | | | | | |
| 5W | 9.7 | 9.3 | 22.2 | 25 | 0.78 | 0.01~300 | 301~50K |
| 7W | 9.5 | 9.5 | 35 | 25 | 0.8 | 0.01~470 | 471~180K |
| 10W | 10 | 9.5 | 48 | 25 | 0.8 | 0.01~470 | 471~180K |
| 15W | 12.5 | 12.5 | 48 | 25 | 0.8 | 0.01~470 | 471~180K |
| 20W | 14 | 13 | 60 | 25 | 0.8 | 0.01~470 | 471~180K |

SQZG

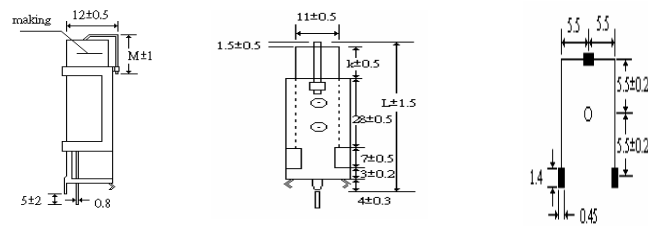

| TYPE | Dimension (mm) | | | Resistance Range(Ω) | |
|------|----------------|-------|-----|---------------------|----------|
| | L±1.5 | K±0.5 | M±1 | WIREWOUND | MOR |
| SQS | | | | | |
| 5W | 30 | 8 | 8 | 0.01~300 | 301~100K |
| 7W | 42 | 17 | 20 | 0.01~300 | 301~100K |
| 10W | 60 | 22 | 25 | 0.1~500 | 501~100K |

SQHG

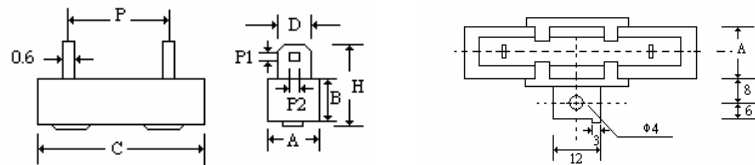
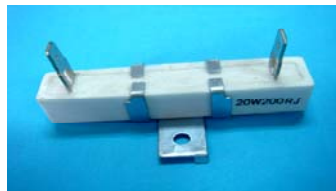

| TYPE | Dimension (mm) | | | | | | | | Resistance Range(Ω) | |
|----------|----------------|------|-------|-----|-----|-------|--------|--------|---------------------|------------|
| | A±1 | B±1 | C±1.5 | P±1 | H±1 | D±0.5 | P1±0.2 | P2±0.2 | WIREWOUND | MOR |
| SQH SQHG | | | | | | | | | | |
| 10W | 10 | 10 | 48 | 32 | 20 | 5 | 2.5 | 2 | 0.01~500Ω | 501Ω~100KΩ |
| 15W | 13 | 11.5 | 48 | 32 | 22 | 5 | 2.5 | 2 | 0.05~500Ω | 501Ω~100KΩ |
| 20W | 13 | 13.5 | 62 | 43 | 24 | 6 | 3.0 | 2.5 | 0.1~500Ω | 501Ω~100KΩ |
| 30W | 19 | 19 | 75 | 56 | 30 | 6 | 3.0 | 2.5 | 0.1~600Ω | 601Ω~100KΩ |

发热体/香熏电阻/电蚊香电阻

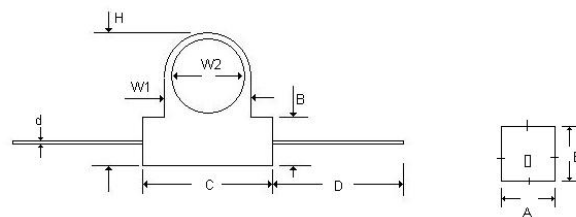

| TYPE | Dimension (mm) | | | | | | | | Resistance Range(Ω) |
|---------|----------------|-------|-----|-----|--------|--------|-----|--------|---------------------|
| | A±0.5 | B±0.5 | C±1 | D±3 | W1±0.5 | W2±0.5 | H±1 | d±0.06 | MOR |
| 3W / 5W | 9.5 | 9 | 19 | 25 | 18 | 14 | 20 | 0.7 | 1K~20K |

注：可根据客户提供的输入电压、温度控制等要求进行设计生产

Note: according to customer input voltage, temperature control requirements of design and production



● 性能 Specification

| Type | Specification | | | | | | | | | | | | | |
|---------------------|-------------------|------|-------|-------|-------|-------|-------|-------|-------|-------|-------|-------|-------|-------|
| Power rating (70°C) | 1W | 2W | 3W | 5W | 7W | 10W | 15W | 20W | 25W | 30W | 40W | 50W | 80W | 100W |
| Max Working | 200V | 350V | 500V | 750V | 1000V | 1000V | 1000V | 1000V | 1000V | 1000V | 1000V | 1000V | 1000V | 1000V |
| Max Overload | 400V | 700V | 1000V | 1500V | 1500V | 1500V | 1500V | 1500V | 1500V | 1500V | 1500V | 1500V | 1500V | 1500V |
| Tolerance | ±1% ±2% ±5% | | | | | | | | | | | | | |
| Operating | -55°C ~ +155°C | | | | | | | | | | | | | |

● 電氣性能 Electrical performance

| | |
|---------------------------------|---|
| Temperature coefficient | WIREWOUND: ± 100PPM/°C; MOR: ± 350PPM/°C |
| Short-time overload | $\Delta R/R \leq \pm(5\%+0.05\Omega)$, with no evidence of mechanical damage |
| Dielectric withstanding voltage | No evidence of flashover, mechanical damage, arcing or insulation breakdown |
| Terminal strength | No evidence of mechanical damage |
| Resistance to soldering heat | $\Delta R/R \leq \pm(1\%+0.05\Omega)$, with no evidence of mechanical damage |
| Solder ability | Min. 95% coverage |
| Temperature cycling | $\Delta R/R \leq \pm(2\%+0.05\Omega)$, with no evidence of mechanical damage |
| Humidity (Steady State) | $\Delta R/R \leq \pm(5\%+0.05\Omega)$, with no evidence of mechanical damage |
| Load life in humidity | $\leq \pm 5\%$ |
| Load life Wire-wound type: | $\leq \pm 5\%$ |

● 表面溫升 Electrical performance

SQP/SQM

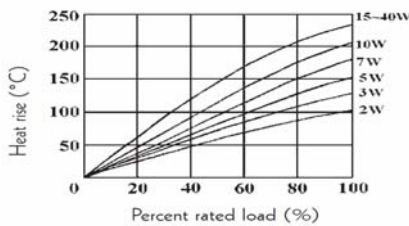

SQZG

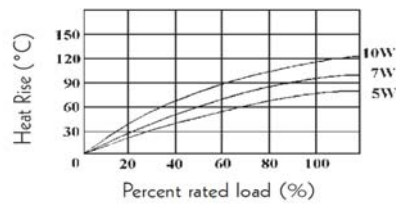

SQZ

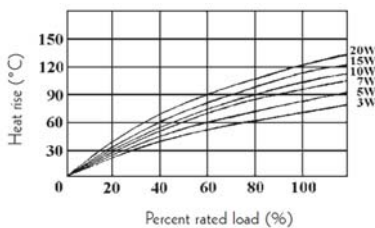

SQHG/SQPG

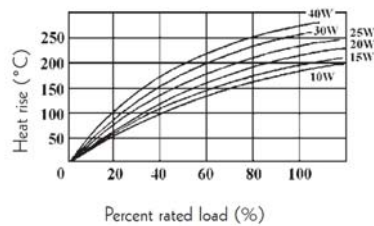

備註：1.我們能按客戶要求生產各種規格的無電感、低電感產品；

2.我們能按客戶要求在現有溫升的基礎上，降低產品使用時的溫度。

Notes: 1. We can produce various specifications according to customer's non-inductive, low inductance products;

2. We can according to customer requirements based on the current temperature, reduce the temperature of product use.